

N SERIES 11

PLUGS

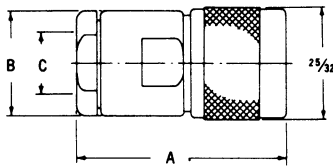

Fig. 1

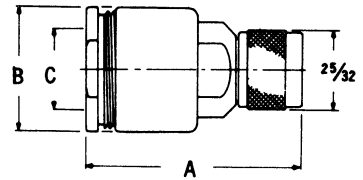

Fig. 2

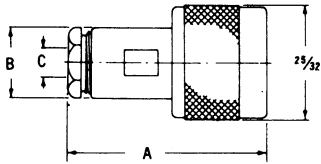

Fig. 3

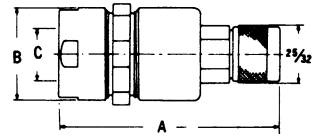
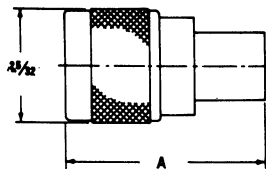

Fig. 4

DELTA PART NO.	FIG.	DIELECTRIC	USED WITH CABLE RG-/U	DIMENSIONS			REMARKS
				A	B	C	
UG-18E/U	1	Teflon	5B, 21A, 143A, 212, 222	1-1/2	3/4	.345	
UG-21B/U	1	Teflon	8A, 9B, 213, 214	1-13/16	11/16	.440	
UG-21E/U	1	Teflon	8A, 9B, 87A, 213, 214, 225	1-1/2	3/4	.442	
UG-21G/U	1	Teflon	8A, 9B, 87A, 213, 214, 225	1-1/2	3/4	.442	Gold Plated Contact
UG-167F/U	2	Teflon	17A, 218	2-1/8	1-5/16	.915	
UG-204D/U	2	Teflon	14A, 217	1-3/4	7/8	.562	
UG-536B/U	3	Teflon	55B, 58C, 141A, 142B, 223	1-3/8	1/2	.224	
UG-557B/U	4	Teflon	118A, 228A	3-3/32	1-5/16	.818	
UG-603A/U	3	Teflon	59B, 62A, 71B, 140, 210	1-3/8	1/2	.258	
UG-982A/U	4	Teflon	18A, 219	3-5/64	1-5/16	.968	
UG-1185/U	1	Teflon	8A, 9B, 87A, 213, 214, 225	1-1/2	3/4	.442	Captive Contact
UG-1185A/U	1	Teflon	8A, 9B, 87A, 213, 214, 225	1-1/2	3/4	.442	Captive Contact
1101-015-A001	3	Teflon	55B, 58C, 141A, 142B, 223	1-3/8	1/2	.224	Captive Contact
1101-021-A001	3	Teflon	59B, 62A, 71B, 140, 141	1-3/8	1/2	.258	Captive Contact
1101-031-A003	3	Teflon	.141 DIA., Semi-Rigid	1-3/8	1/2	.144	Solder Assembly
1101-043-A001	3	Teflon	180B, 195A	1-3/8	1/2	.160	Captive Contact
1101-030-A001	1	Teflon	126	1-1/2	3/4	.291	Captive Contact
1101-029-A000	3	Teflon	122	1-3/8	1/2	.177	
1101-049-A000	1	Teflon	225	1-1/2	3/4	.453	
1101-011-A000	2	Teflon	34B	2-7/32	1-5/16	.656	
1101-027-A001	1	Teflon	115A	1-1/2	3/4	.442	Captive Contact
1101-018-A001	3	Teflon	58C, 142B	1-3/8	1/2	.209	Captive Contact
1101-032-A001	3	Teflon	141A	1-3/8	1/2	.198	Captive Contact
1101-032-A000	3	Teflon	141A	1-3/8	1/2	.198	
1101-036-A001	3	Teflon	174, 188A	1-3/8	1/2	.120	Captive Contact
1101-038-A001	3	Teflon	178B, 196A	1-3/8	1/2	.084	Captive Contact
1101-027-A000	1	Teflon	115A	1-1/2	3/4	.442	
1101-001-A001	1	Teflon	5B, 21A, 143A, 212, 222	1-1/2	3/4	.345	Captive Contact
1101-049-A001	1	Teflon	225	1-1/2	3/4	.453	Captive Contact



DELTA PART NO.	DIELECTRIC	USED WITH CABLE RG-/U	DIMENSIONS		REMARKS
			A		
1103-002-A000	Teflon	8A, 213	1-25/64		Short Crimp
1103-005-A000	Teflon	9B, 214	1-25/64		Short Crimp
1103-033-A000	Teflon	141A, 142B	1-17/32		Short Crimp
1103-027-A000	Teflon	115A	1-25/64		Short Crimp

N SERIES 11

RIGHT ANGLE PLUGS

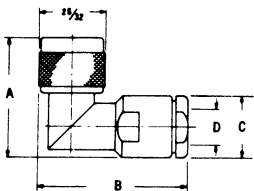

Fig. 1

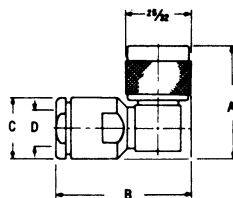

Fig. 3

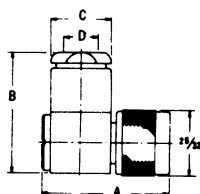
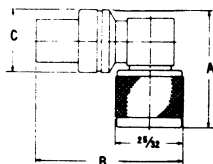

Fig. 2

DELTA PART NO.	FIG.	DIELECTRIC	USED WITH CABLE RG-/U	DIMENSIONS				REMARKS
				A	B	C	D	
UG-594B/U	3	Teflon	8A, 9B, 87A, 213, 214, 225	1-15/32	1-7/8	3/4	.442	Captive Contact
1105-015-A000	2	Teflon	55B, 58C, 141A, 142B, 223	1-9/16	1-9/32	1/2	.224	Cube Body
1104-004-A001	1	Teflon	8A, 9B, 87A, 213, 214, 225	1-15/32	1-7/8	3/4	.442	Captive Contact
1105-004-A000	3	Teflon	8A, 9B, 87A, 213, 214, 225	1-19/64	1-17/32	3/4	.442	Cube Body
1105-021-A000	2	Teflon	59B, 62A, 71B, 140, 210	1-17/32	1-9/32	1/2	.258	Cube Body
1104-027-A001	1	Teflon	115A	1-15/32	1-7/8	3/4	.442	Captive Contact
1105-001-A000	3	Teflon	5B, 21A, 143A, 212, 222	1-19/64	1-17/32	3/4	.345	Cube Body
1105-015-A001	3	Teflon	55B, 58C, 141A, 142B, 223	1-11/32	2-1/64	9/16	.224	Cube Body, Captive Contact
1105-018-A001	3	Teflon	58C, 142B	1-11/32	2-1/64	9/16	.209	Cube Body, Captive Contact
1104-049-A001	1	Teflon	225	1-15/32	1-7/8	3/4	.453	Captive Contact
1105-036-A001	3	Teflon	174, 188A	1-11/32	2-1/64	9/16	.120	Cube Body, Captive Contact



DELTA PART NO.	DIELECTRIC	USED WITH CABLE RG-/U	DIMENSIONS			REMARKS
			A	B	C	
1107-005-A000	Teflon	9B, 214	1-25/64	1-49/64	3/4	Short Crimp
1107-027-A000	Teflon	115A	1-25/64	1-49/64	3/4	Short Crimp
1107-002-A000	Teflon	8A, 213	1-25/64	1-49/64	3/4	Short Crimp